



## Public Art Commission Opportunity **East Bristol Liveable Neighbourhood: Surface Artworks**

**Total budget: £32,500**

**Five individual commissions at £6,500 each**

**Submission date: 10am, Friday 1 November**

Bristol City Council (BCC) would like to engage several Artists (minimum of two and up to a maximum of five) to deliver artistic interventions in the form of surface artworks for new parklets and at key locations within East Bristol Liveable Neighbourhood (EBLN) trial scheme.

Supported by the Arts Development team, selected artists will work collaboratively to explore local context and work with local communities to co-create locally distinctive and cohesive artworks across the East Bristol Liveable Neighbourhood.

Five sites have been identified for artworks within the trial scheme.

1. Barton Hill Triangle parklet, Ducie Road
2. Marsh Lane junction with Avonvale Road
3. Victoria Avenue (with Redfield Educate)
4. Queen Ann Road / Avonvale Road footways (with Barton Hill Academy)
5. Beaufort Road parklet (with St Patricks Catholic Primary School)

The artworks will be in the form of painted surface designs or artworks on Tarmac surfaces. The aspiration is that if / when the scheme becomes permanent the artworks will be re-installed in Thermoplastic for longer term durability.

Maps of the areas can be found below.

### **Engagement**

It is vital that the artworks engage and involve local people in the creative process through meaningful co-design and co-creation.

As the work will involve two or more Artists working at the same time, we would like to encourage a collaborative and pooled approach to the community and stakeholder engagement as well as to artistic approach to coordinate colour palette / motifs for

example. We envisage that it may involve implementing an ongoing creative and community working group to ensure community review and involvement.

An initial meeting with Arts Development and Transport Officers and commissioned Artists will be organised on site or via Teams, to meet each other and to discuss and assign engagement and overarching design and aesthetic principles for the EBLN.

## **Project Overview:**

### **Liveable Neighbourhoods**

Bristol City Council wants local neighbourhoods to be 'liveable' so that they are safe, healthy, inclusive, and attractive places where everyone can breathe clean air, have access to better quality green and play space, and feel a part of a community.

Liveable Neighbourhoods seek to provide more space for community assets, such as trees, benches, cycle parking, and artwork, as well as high quality infrastructure for walking, wheeling, scooting, cycling, and sustainable transport.

This is achieved by removing traffic cutting through an area by the strategic placement of modal filters. Modal filters can be implemented using bollards, barriers, and planters. They generally seek to prevent access by motorised vehicles but allow other modes (walking, wheeling, scooting, cycling, buses) to filter through unimpeded.

By reducing the number of vehicles in neighbourhoods, local streets can be redesigned from places that simply facilitate the movement of traffic to spaces that prioritise people and can cater for other uses such as play, community events and social interaction and are generally more pleasant and pollution free environments.

Liveable Neighbourhood objectives:

- Transform our neighbourhoods into places where people want to spend time, can interact with neighbours, and enjoy their unique identities
- Reflect the needs and characteristics of the local community and increase the sense of pride and belonging
- Improve levels of physical and perceived safety in our communities
- Improve local accessibility and connectivity to shops, schools, services, and other amenities for everyone to move around safely and sustainably
- Improve residents' physical and mental health and wellbeing
- Contribute to reducing inequality and opening opportunities for all in our communities
- Increase resilience and support the economy by improving local centres and high streets and access to jobs, skills, and training
- Improve local and citywide air quality and contribute to meeting the climate and ecological emergency

For more information about East Bristol Liveable Neighbourhood go to [www.bristol.gov.uk/eastbristolliveableneighbourhood](http://www.bristol.gov.uk/eastbristolliveableneighbourhood)

## **Artist commissions**

We are looking for Bristol based artists whose practice involves working with communities and place; engaging and liaising with stakeholders, tapping into local assets and engaging and involving local people in the creative process. It is vital the end work reflects the locality and is designed with and for the people and communities that live and use the spaces most.

The Artist/s will be required to lead a minimum of four workshops per commission and invite the community to contribute their creative input into the designs. Ideas for engagement include but are not limited to:

- Creative and Co-design workshops with local community groups (to be identified with Transport & Arts Development Teams)
- Creative and Co-design workshops in schools
- Local conversations – visiting community groups, local shops, researching their interests
- Artist talks and inspirational projects
- Online engagement via local social media groups, websites etc.
- Live community painting events to realise and install the artworks
- Celebration / launch of the artwork

Extensive consultation and engagement have taken place and is ongoing with local communities and stakeholders. We wish the process of this commission to continue and widen local conversations and help stimulate ideas for activation and use of these spaces for other events and initiatives and to aid the adoption and embedding of the Liveable Neighbourhood trial scheme.

### **Budget: Five commissions at £6,500.00 per commission**

The commission budget is inclusive of all artist fees to cover: research & development; at least four community or stakeholder workshops per commission plus workshop materials, event promotion, room hire if necessary; regular meetings and liaison with BCC Project Team, community leads and collaborative artist group as required; co-design and co-creation of concept designs; production of all final design artwork; installation and oversight of the installation of the artwork, preferably involving stakeholders and volunteers from the community.

A separate budget for materials and management of the artwork installation will be available and will be held and managed by BCC. BCC officers from Arts Development and Transport Teams will liaise with Artist/s and assist in the management for the installation to include procurement of materials and management of the site, Health & Safety & Risk Assessments & Method Statements, licensing & permissions.

The above fees exclude Value Added Tax, which shall be added where the Artist is registered for VAT. It is the Artist's responsibility to inform the Client if they are registered for VAT purposes and to supply a VAT invoice.

## Evaluation

For awareness, BCC intends surveying artwork participants, collaborators and residents to collect data to measure perception of the EBLN trial scheme; pride in place; health & wellbeing objectives. The Artist/s may be required to collaborate with this process (e.g. passing on anecdotal evidence from workshops and helping to promote surveys at workshops).

## Timeline

**This programme is time constrained and interested artists should be confident that they can meet the project timetable. Please see below for the timetable.**

## Eligibility criteria

Selection will be prioritised to artists living and/or working within Bristol and the surrounding area. We would be especially interested to hear of any specific connection to the East Bristol Liveable Neighbourhood area.

## Safeguarding

The Artists will be required to hold a DBS certificate at the appropriate level to cover any instance where a workshop leader/ facilitator is not present or does not hold an appropriate DBS certificate.

The successful artist/s will have completed up to date safeguarding training equivalent to that required by Bristol City Council and will be required to complete a safeguarding risk assessment where necessary.

## Insurance

The Artist will be expected to hold public liability insurance to a minimum value of £5 million and public indemnity insurance to minimum value of £5 million.

## How to apply and submission process

Artists are invited to make an Expression of Interest to [artsdevelopment@bristol.gov.uk](mailto:artsdevelopment@bristol.gov.uk) by **10am on Friday 1 November**.

We will be holding one in person on site information session and one online information session for artists to hear more about the commission and ask any questions. Please email [artsdevelopment@bristol.gov.uk](mailto:artsdevelopment@bristol.gov.uk) to book your place.

**12 – 1.30pm, 21/10/2024** outside Wellspring Settlement 43 Ducie Rd,  
Bristol, BS5 0AX

**2 – 3pm, 22/10/2024** online (Teams link)

If you can't make either of these times and have any questions or would like to arrange an informal conversation with the Arts Development Officer, please contact [artsdevelopment@bristol.gov.uk](mailto:artsdevelopment@bristol.gov.uk)

## What to include

Your Expression of Interest should include:

- Your name, contact details, postcode and preferred pronoun.
- Images of relevant previous projects / website links
- A statement (2 A4 pages maximum) outlining your suitability for this work including:
  - How you feel your work and approach suits the commission and if you have any preference of site/s or number of sites
  - Examples of skills, experience, and personal attributes you can bring to the project
  - Connection to Bristol and/or the East Bristol Liveable Neighbourhood area
  - An example of strong community engagement and co-design or co-creation you have led that involved collaborating with stakeholders, such as local businesses, community organisations, residents, youth or school groups
  - How you will approach the work, with an outline of your fee and timeline demonstrating how you will manage the budget and tight timescale.
- A referee who can talk about a commission you have undertaken in the public realm with strong community focus.

## Selection criteria:

The artist will be shortlisted / selected based on the following criteria using the scoring system outlined below:

- Demonstrated artistic ability and track record of creating work in public spaces
- Demonstration of community engagement and involvement of stakeholders in the artistic process
- Ability to work within the timeline and budget

Score	0	1	2	3
Rationale	Unacceptable - not been answered or the answer raises serious doubts.	Partially answered but reservations remain about the clarity / robustness / credibility of the answer.	Acceptable – answered to a satisfactory standard.	Excellent – fully answered and exceeds satisfactory standards.

Shortlisted artists will then be reviewed, and final artists selected by a Community Commissioning panel involving stakeholders from each of the five sites. This date is provisionally set for the **Friday 8 November**. Selected artists will be informed following this panel meeting.

At Bristol City Council we value the diversity of the city we serve. We therefore welcome expressions of interest for this opportunity from Artists from all sections of the community. If you or someone you are supporting needs this information in a different format, please do get in touch so we can make sure this opportunity is open to you.

### **Programme and timetable**

12pm 21/10/14	Information session - in person on site
2pm 22/10/24	Information Session - online
10am 1/11/24	Deadline for Expressions of Interest
8/11/24	Community Commissioning panel / selected artists informed
w/c 11/11/24	Community / schools workshops planning meeting
w/c 18/11 – 13/12/24	Engagement and workshop delivery - regular meetings with Commissioning Panel to agree concept designs
w/c 16/12/24	BCC Highways design approval
w/c 6/1/25	Procurement of materials and production of H&S / RAMS for installation
w/c 27/1/25	Artwork installation commences
28/2/25	Commissions completed

### **Management and support**

Artists will be commissioned and contracted by Bristol City Council with support and steer led by the Arts Development team who will broker access to other council departments support. Day to day project management and liaison will be with Arts Development and Transport Officers. They will support you from briefing, introducing you to community representatives, overseeing your engagement events and milestones for delivery such as concept and detailed design sign off, up to installation and handover.

There is a budget of up to £500 per commission to support access requirements for artists, if required.

# Supporting documents / links

[East Bristol Liveable Neighbourhood | Ask Bristol Consultation and Engagement Hub](#)  
[Liveable neighbourhoods handbook \(bristol.gov.uk\)](#)

## Maps of the identified sites

(black dots indicate areas where artworks can be applied for all sites except Queen Ann & Avonvale where the footways will be used)

### Barton Hill Triangle parklet - Ducie Road

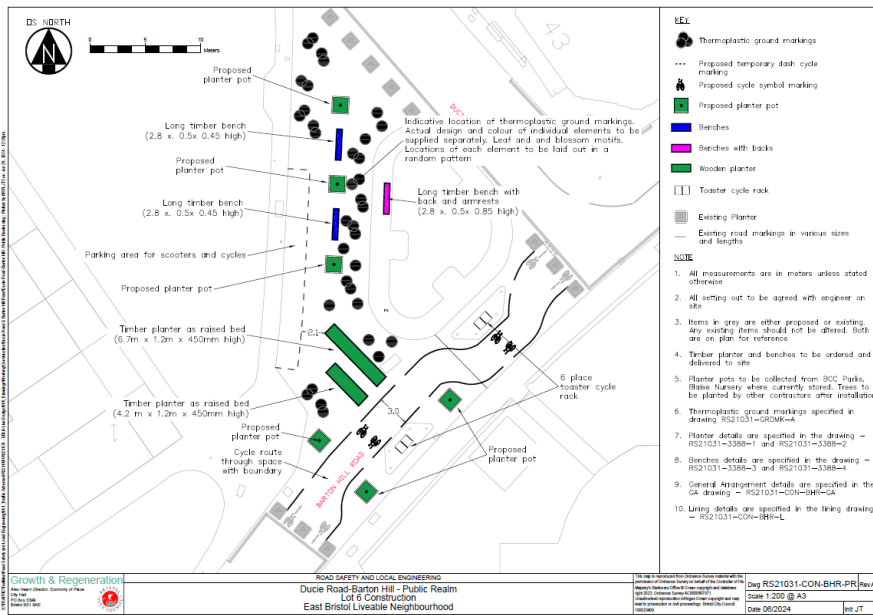

### Marsh Lane junction with Avonvale Road

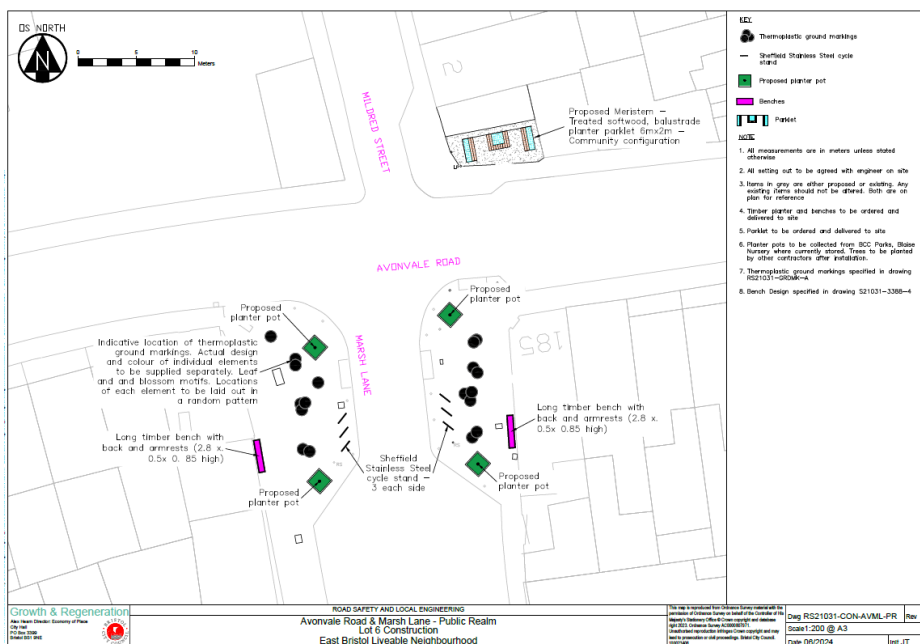

## Victoria Avenue with Redfield Educate

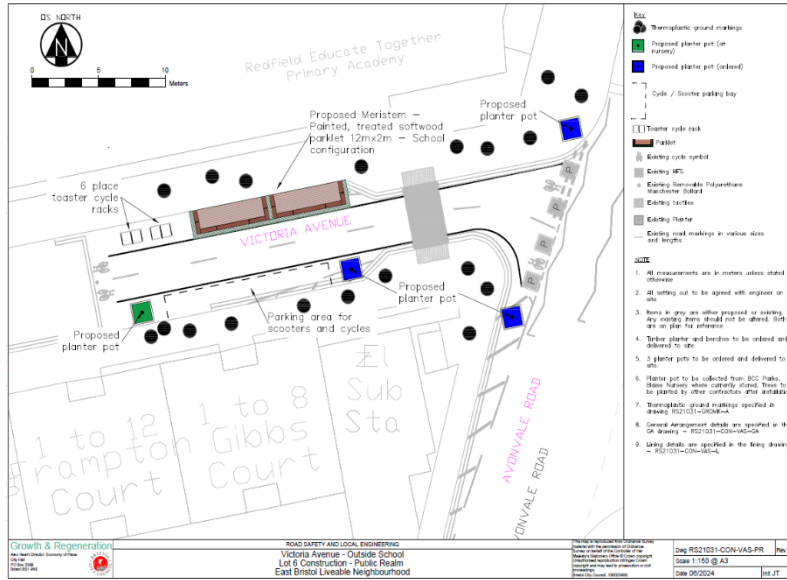

## Queen Ann Road / Avonvale Road footways with Barton Hill Academy





# Beaufort Road parklet with St Patricks Catholic Primary School

